

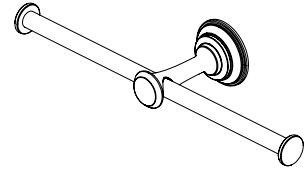

Location:



### 583DTP Double Toilet Paper Holder Specification Submittal

<b>Model Numbers</b>	<b>Options/Modifications</b>
<input type="checkbox"/> <b>583DTP</b> Double Toilet Paper Holder	<input type="checkbox"/> <b>STN</b> Satin Nickle finish <input type="checkbox"/> <b>MB</b> Matte Black finish <input type="checkbox"/> <b>BBZ</b> Brushed Bronze finish
<b>Feature Highlights</b>	<b>Warranty</b>
<ul style="list-style-type: none"><li>• Metal construction</li><li>• Standard finish is polished chrome</li><li>• RA-09132 mounting hardware included</li></ul>	<p><b>Limited Lifetime</b> - to the original end purchaser in consumer/residential installations. <b>10 Years</b> - for commercial/industrial installations. Refer to <a href="http://www.symmons.com/warranty">www.symmons.com/warranty</a> for complete warranty information.</p> 

### Architectural/Engineering Specification

Symmons \_\_\_\_\_ Double Toilet Paper Holder includes metal construction, polished chrome standard finish, and RA-09132 mounting hardware. 10 Year Commercial Warranty. Available options: "STN - Satin Nickel finish", and "MB - Matte Black finish".

### Dimensions

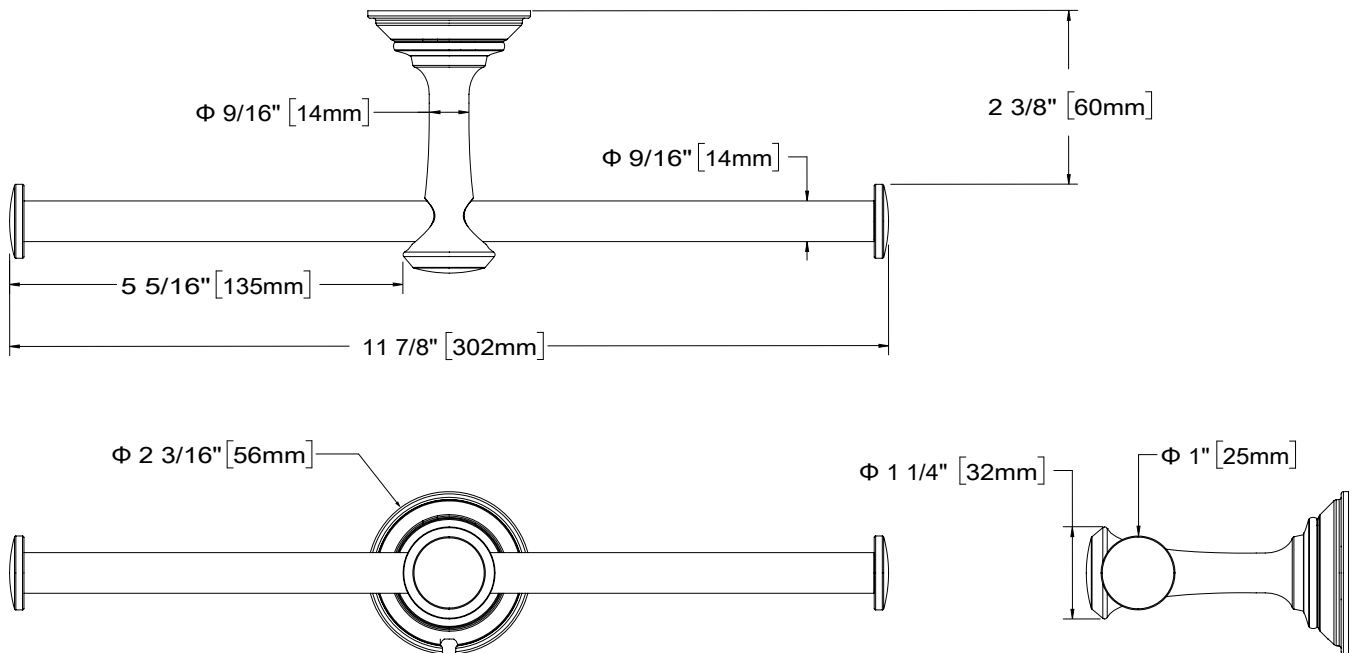

**Note:**  
1) Dimensions subject to change without notice.