



S6960B, S6960E
Sensor Lavatory Faucet
Operation and Maintenance Manual



Warranty

Limited Lifetime - for residential installations.
10 Years - for commercial/industrial installations.
Refer to www.symmons.com/warranty for complete warranty information.



Product Care

Clean finished trim area with a soft cloth using mild soap and water or a non-abrasive cleaner, and then quickly rinse with water.

Tools Required

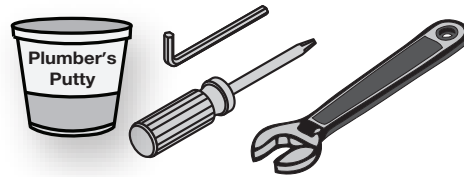

Installation

For uneven or porous surfaces use Plumber's Putty or silicone

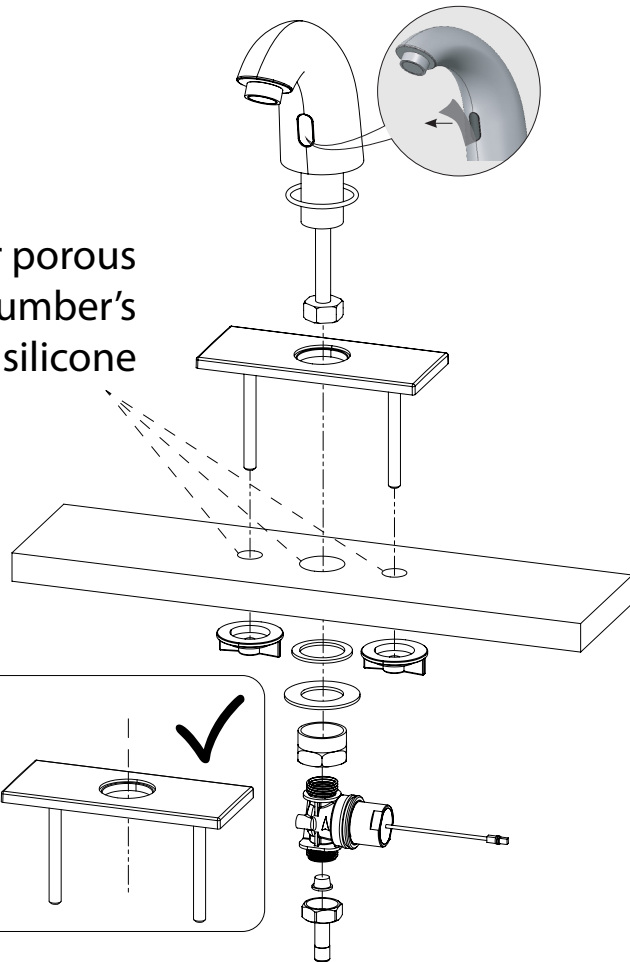

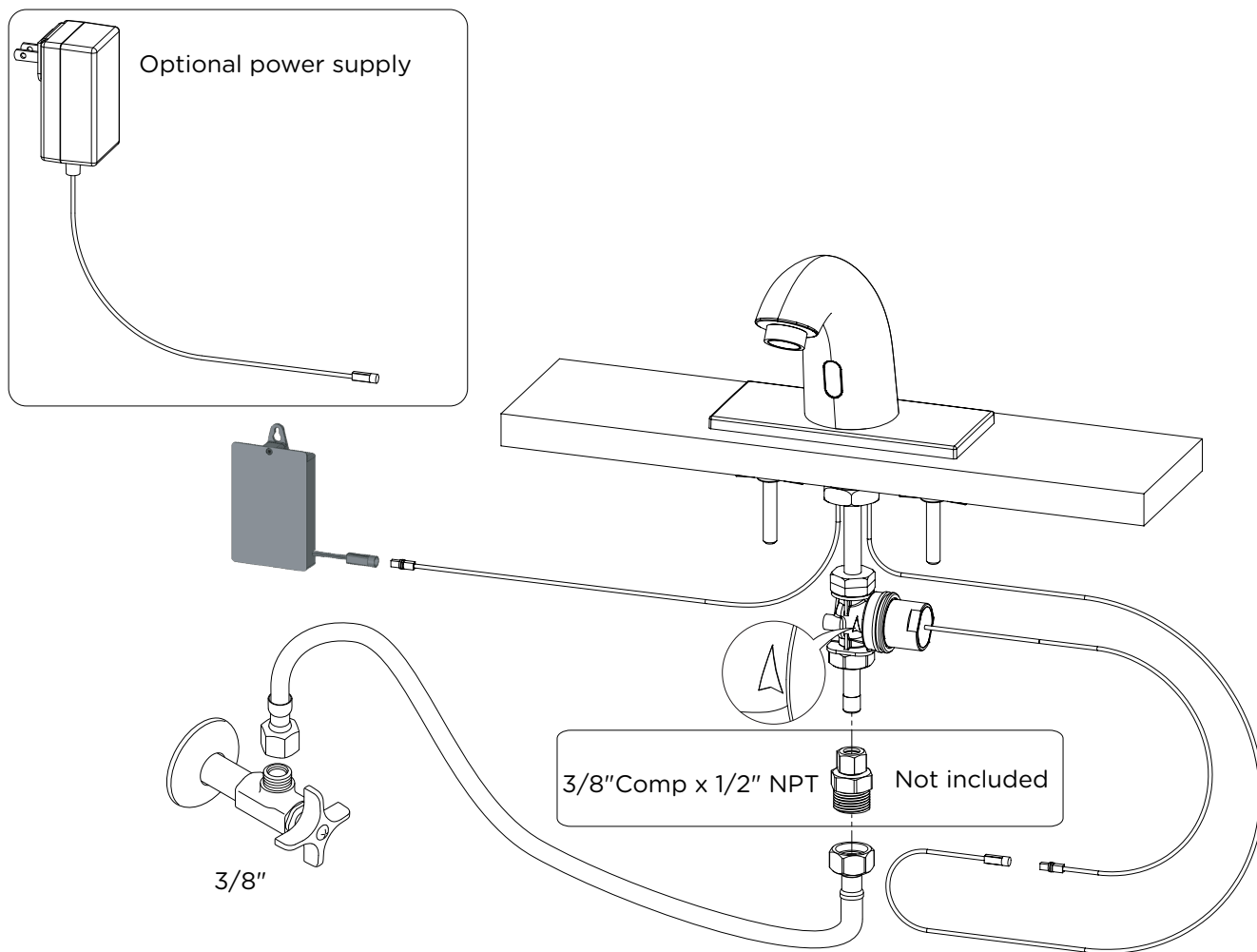
Faucet Mounted + Battery Box Installation for S6960B
Faucet Mounted + Transform Installation for S6960E (Optional)**IMPORTANT:**

1. Wait 10 seconds before operating the system.
2. If the range is unsatisfactory, refer to the section titled "Settings adjustment".



Adjusting the settings with the remote control

If necessary, the sensor settings can be adjusted as following:

Shut off the water supply. In order to adjust the sensor with the remote control, hold the remote control straight in front of the sensor in a distance of about 6-8” (15-20cm). Choose the function you want to adjust by pressing once on one of the function buttons. After pressing once on a specific function button, a quick flashing of the LED at the front of the sensor will occur. At this stage, you can change the setting by pressing the (+) or the (-) buttons, every push will increase or decrease one level. After finishing the adjustment, turn the water supply back on.



DETECTION RANGE: Only if necessary, use the remote control to adjust the sensor range as follows:

Press the RANGE button. Wait until a quick flashing of the LED in the sensor eye is perceived. Then, press + to increase the one level and – to reduce it every push will increase or decrease one level.

NOTE: Once you have changed the detection range with the remote control, this distance will be remembered by the sensor, even if the power source is disconnected.

	<p>DELAY IN TIME: If required, the delay in time can also be modified as follows: Press the IN button. Wait until a quick flashing of the LED in the sensor eye is perceived. Then, press + to increase the delay in time and – to reduce it.</p>
	<p>DELAY OUT TIME: This button allows modifying the flushing start time after the user moves away from the product. A delay out time close to 0 will save more water. An increased delay out time will make the user experience more comfortable.</p> <p>If required, the delay out time can be modified as follows: Press the OUT button. Wait until a quick flashing of the LED in the sensor eye is perceived. Then, press + to increase the delay out time and – to reduce it.</p>
	<p>TEMPORARY OFF FUNCTION: This function is ideal to perform any kind of activity in front of the sensor without operating the system (for example, cleaning).</p> <p>The product will remain shut for 1 minute when this button is pressed once. To cancel this function and to return to normal operation press the On/Off button again or wait 1 minute.</p>
	<p>RESET BUTTON: This function restores all the factory settings except for the sensor range. If required, press the Reset button and without releasing it, press the + button once.</p>
	<p>SECURITY TIME: The Security time, prevents continuous flushing of water due to reflections or vandalism. By default, if the sensor is covered for more than 90 seconds the water flow will shut automatically. To resume regular operation any obstruction must be removed.</p> <p>Press the SEC button. Wait until a quick flashing of the LED of the sensor eye is perceived. Then, press + to increase the security time and – to reduce it.</p>
	<p>24 HOUR HYGIENE FLUSH: This model includes a 24 hours hygiene flush which is disabled. To activate the hygiene flush, press the clock button. Wait until a quick flashing of the LED in the sensor eye is perceived. Then press + to activate the hygiene flush. To disable it again, press – to deactivate it.</p>
	<p>COMFORT FLUSH: If your model includes a COMFORT FLUSH setting, it can be activated by pressing the flush button.</p> <p>When the button is pressed, one blink of the blue in the sensor eye is perceived. The pre-programmed flush cycle will take place then.</p> <p>The Comfort flush cannot be interrupted or deactivated by pressing any button until it is over.</p>

Troubleshooting

PROBLEM	INDICATOR	CAUSE	SOLUTION
No water coming out of the faucet:	1. Sensor flashes continuously when user's hands are within the sensor's range	Low battery	Replace battery
		2. LED in the sensor does not flash once when user's hands are within the sensor's range	1. Range is too short
	2. Range is too long		Decrease the range by using the remote
	3. Battery is completely used up		The battery must be replaced
	4. Unit is in "Security Mode"		
	5. Sensor is picking up reflections from the washbasin or another object		Eliminate cause of reflection or adjust sensor range
	3. LED in the sensor flashes once when user's hands are within the sensor's range	1. Connectors between the electronic unit and solenoid are disconnected	Connect the electronic unit connectors to the solenoid
		2. Debris or scale in solenoid	Unscrew solenoid, pull out the plunger and the spring from the solenoid and clean them. Use scale remover material if needed. When replacing the plunger, please make sure that the spring is in vertical position.
			3. The central orifice in the diaphragm is plugged or the diaphragm is torn
		4. The water supply pressure is higher than 116 PSI	Reduce the supply water pressure
5. The water supply pressure is under 8 bars and yet the pressure in the faucet's body is higher. This situation could be caused by a sudden increase in the water supply pressure that the back check prevents from dropping, even after water supply pressure drops under 8 bars.		Shut off water supply stop and unscrew the inlet to the solenoid to relieve the pressure	
Water flow from spout does not stop:	1. Sensor flashes once when user's hands are within the sensor's range	Debris or scale in diaphragm	Clean the orifice or replace diaphragm
		2. LED in the sensor does not flash once when user's hands are within the sensor's range	1. Sensor is dirty or covered**
	2. Sensor is picking up reflections from the washbasin or another object		Decrease the range or eliminate cause of reflection
	Water flow diminished		Filter or aerator is clogged

⚠ WARNING: This product can expose you to chemicals including lead, which is known to the state of California to cause cancer, birth defects, or other reproductive harm. For more information, go to www.P65Warnings.ca.gov.